

## 68 O'NEAL ROW ASSEMBLY INSTRUCTIONS

Apply glue to the red area.  
Use the bases to stabilise the building.

If you wish to place a backing material behind your windows (a good suggestion that we have used is reflective foil card, available from art and stationary stores), do not glue the base in place at this time, wait until after painting the main building. You will still need to slot the base in place to assist with the gluing of the facade pieces however.

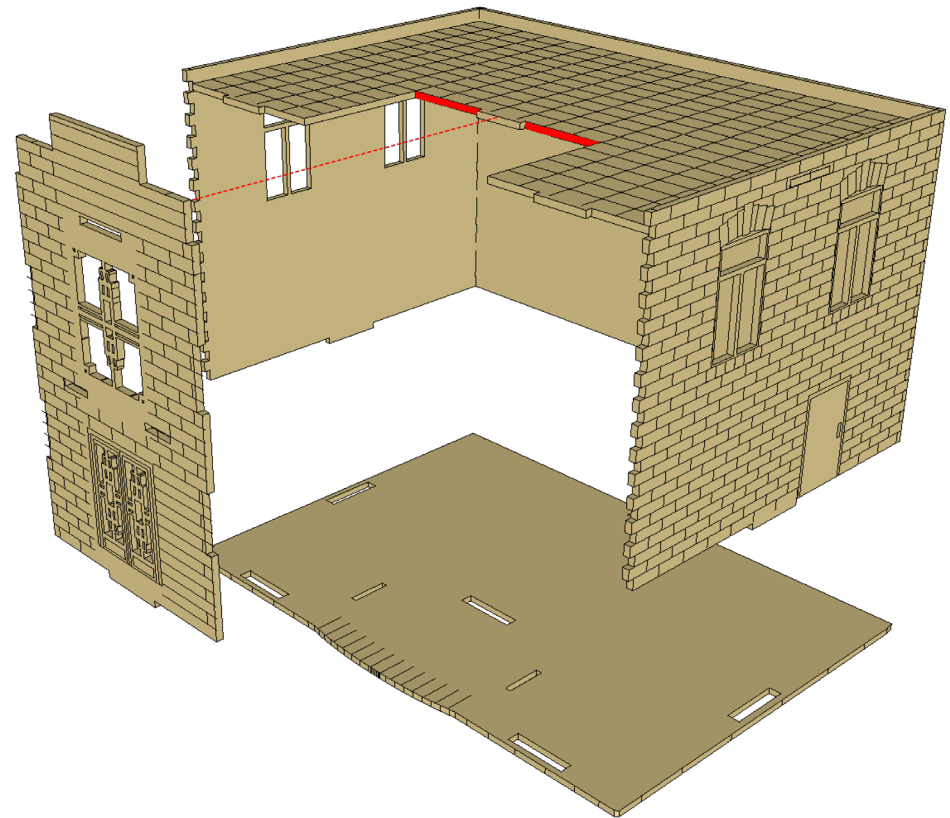
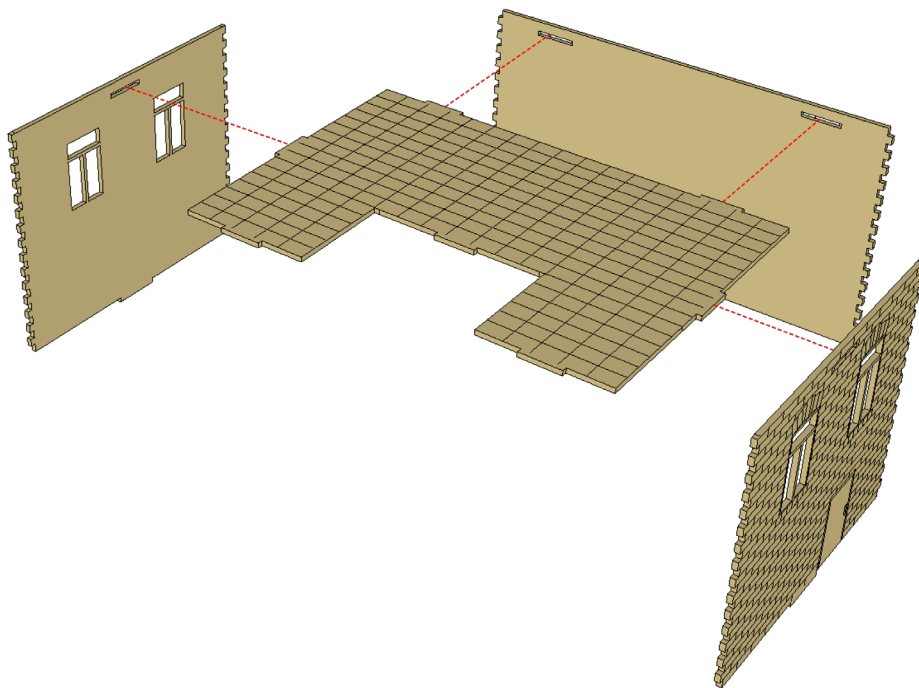

## 68 O'NEAL ROW ASSEMBLY INSTRUCTIONS

If you wish to place a backing material behind your windows (a good suggestion that we have used is reflective foil card, available from art and stationary stores), do not glue the base in place at this time, wait until after painting the main building. You will still need to slot the base in place to assist with the gluing of the facade pieces however.

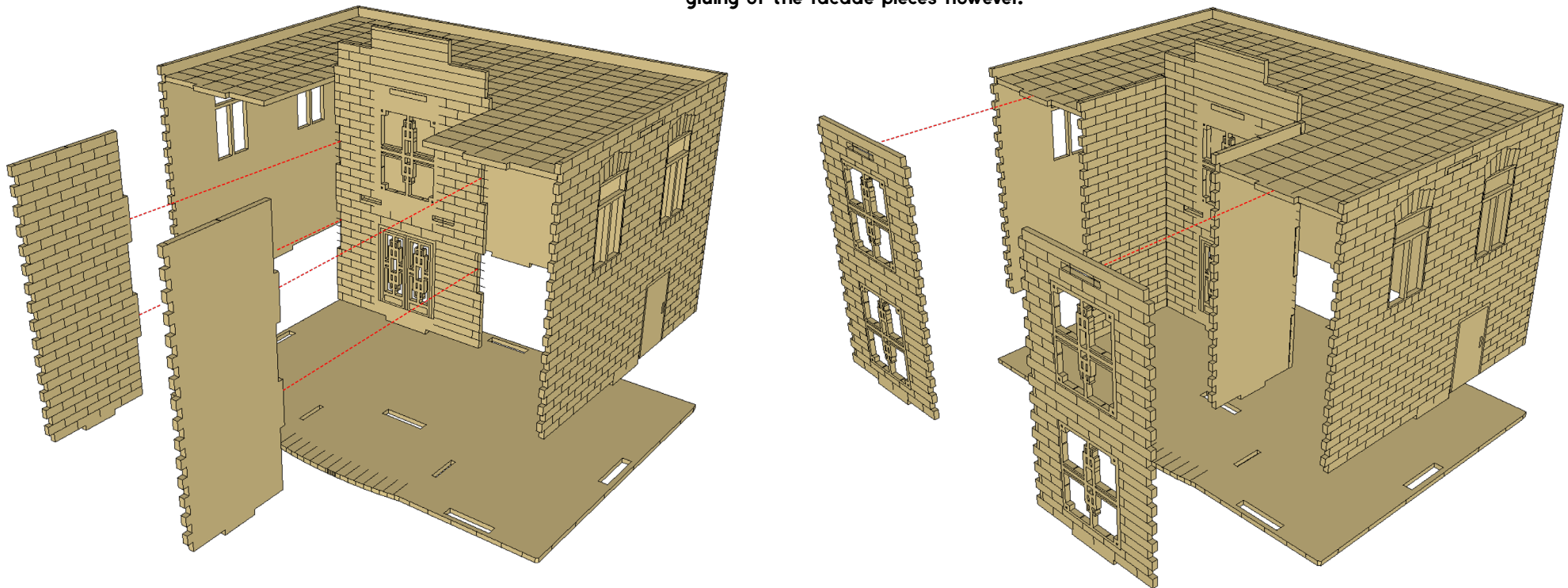

# 68 O'NEAL ROW ASSEMBLY INSTRUCTIONS

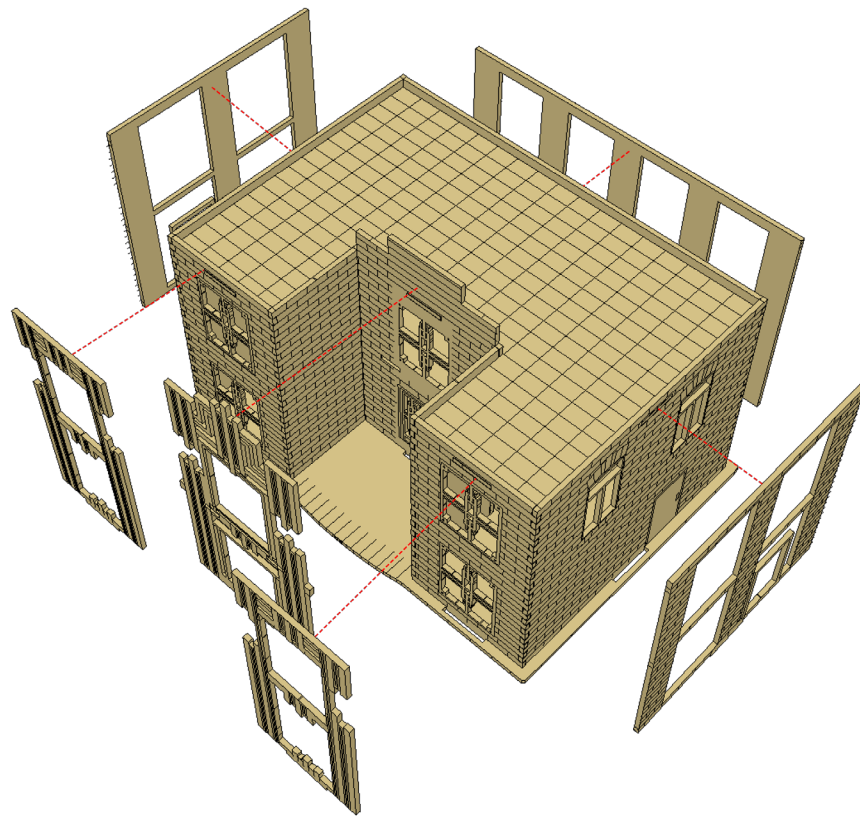

Glue the roof trim pieces following the numbered order.

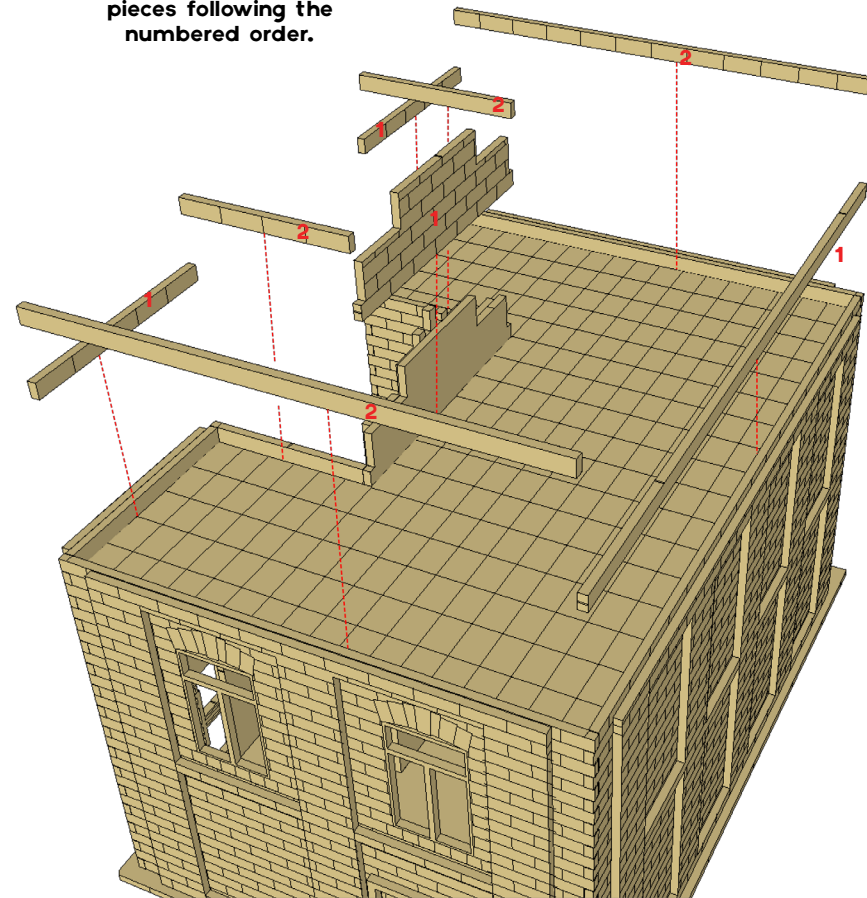



# 68 O'NEAL ROW ASSEMBLY INSTRUCTIONS

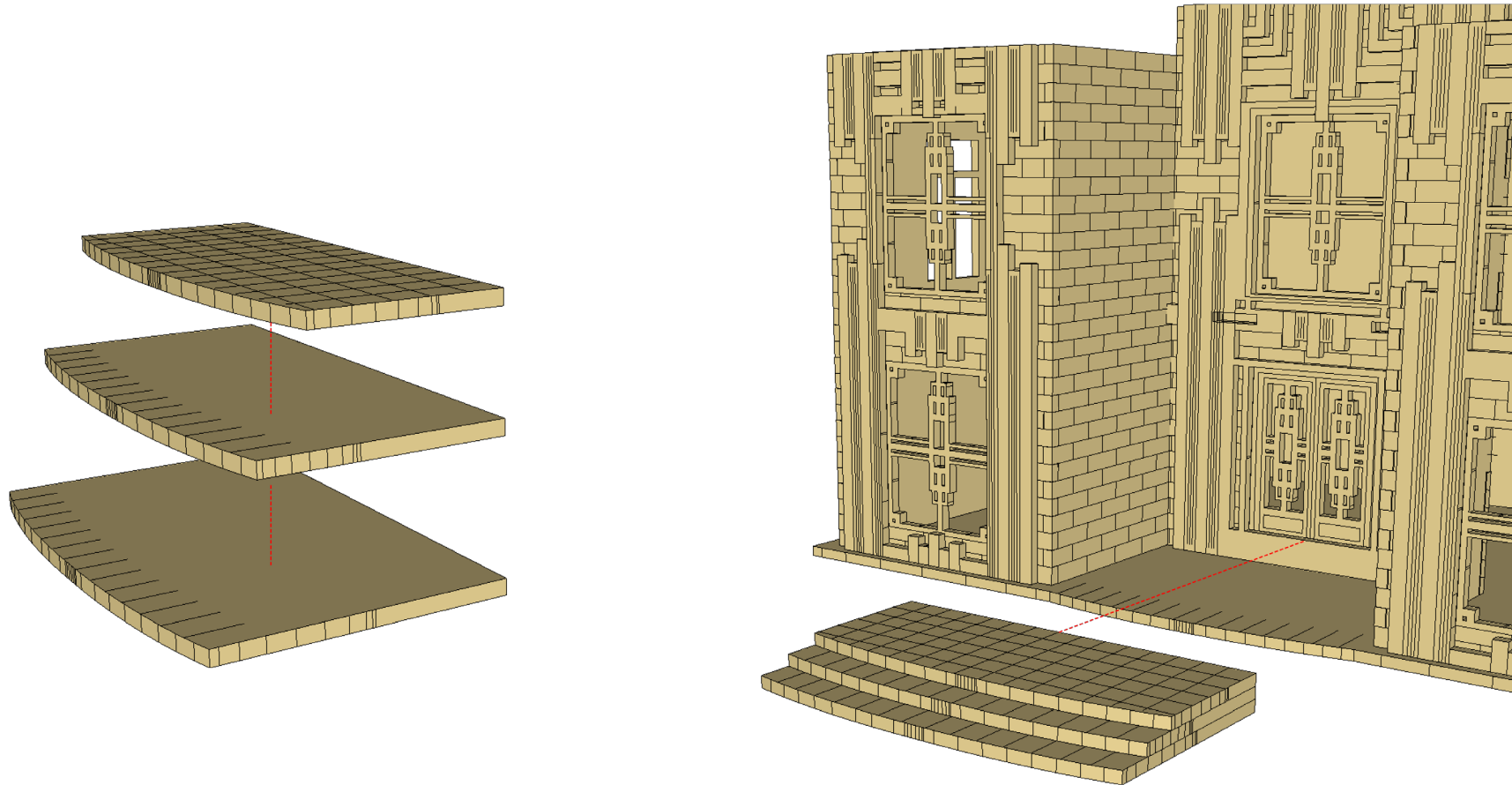

# 68 O'NEAL ROW ASSEMBLY INSTRUCTIONS

Glue the red support pieces in place in roughly the centre of where the balcony will sit. Dry fit the balcony to get your positioning correct.

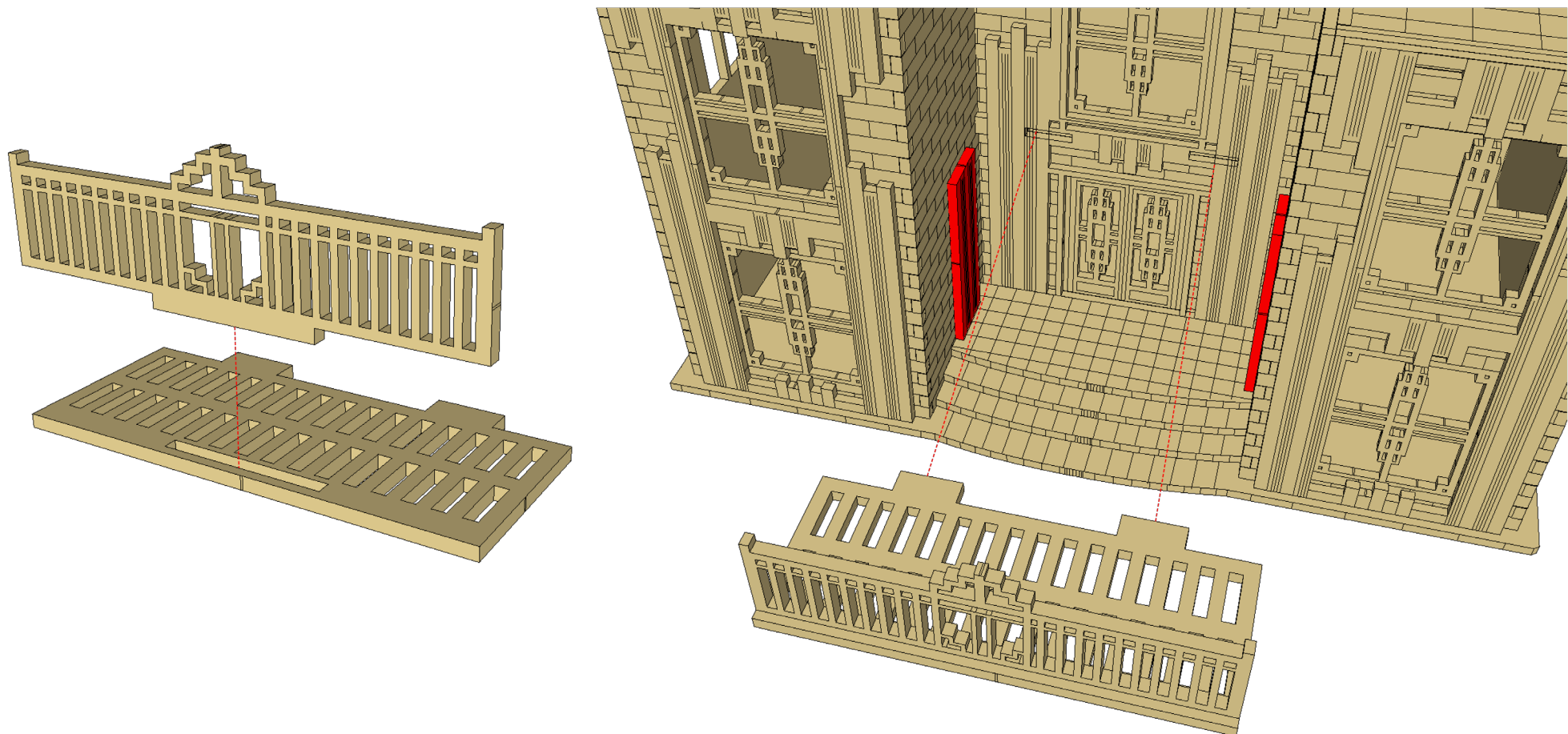

Line up the red pieces with the supports underneath the balcony

